

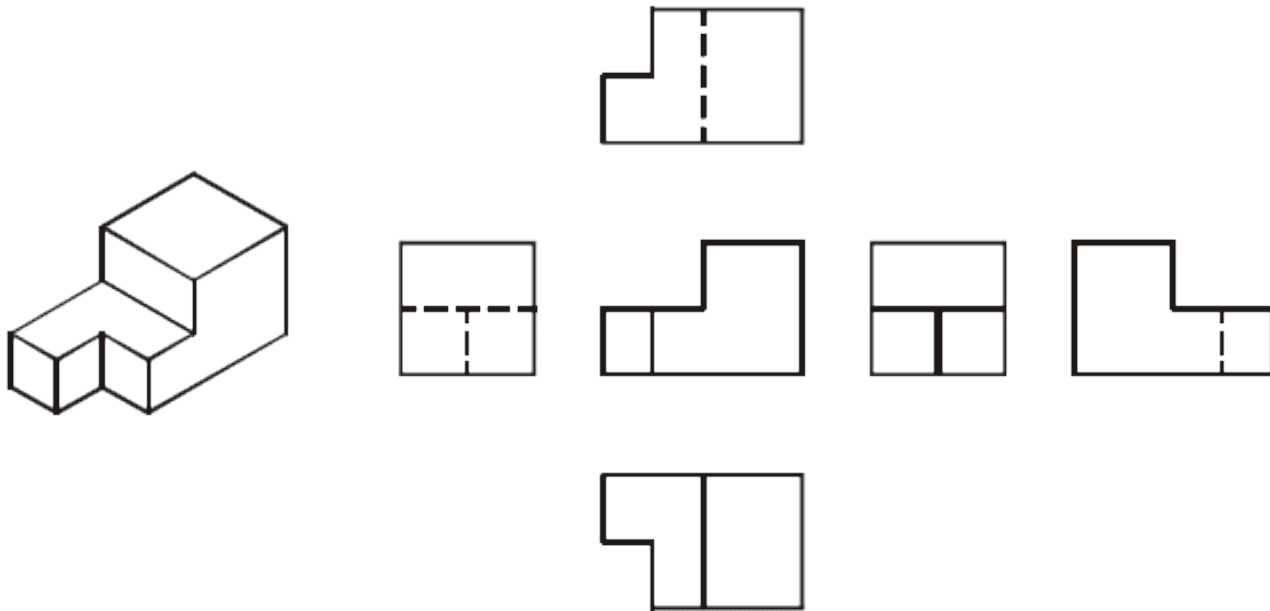

Vistas principais

Vistas principais

- Como organizar as vistas principais na folha de desenho?



Diedro

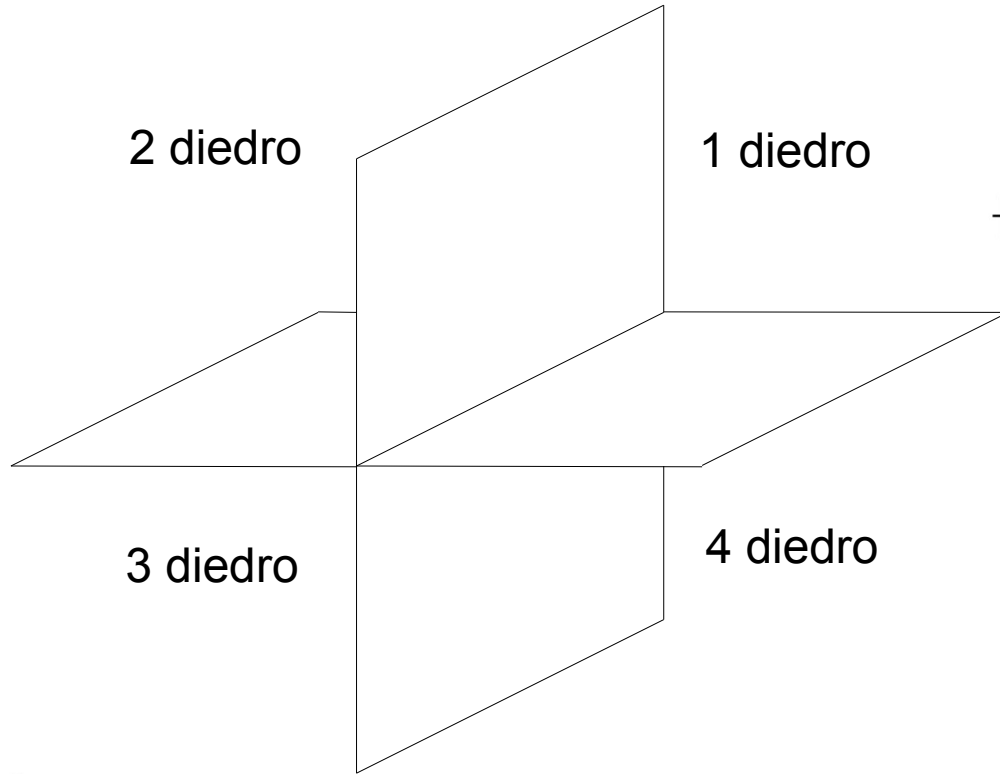

Brasil,
Europa,
outros

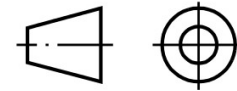

EUA,
Canada

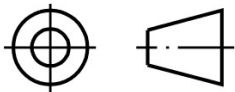

Cubo de projeção

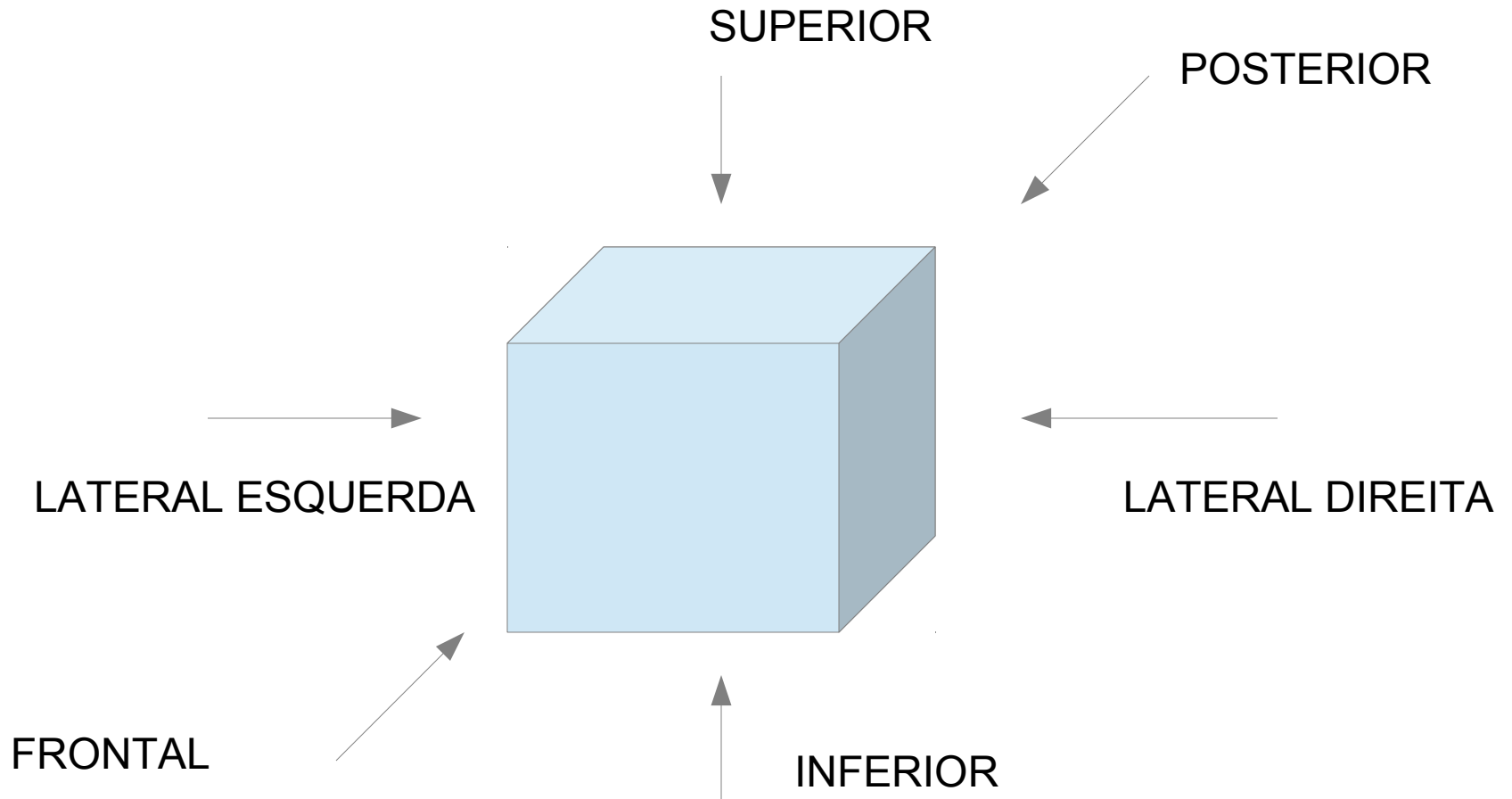

Posicionamento 1 diedro

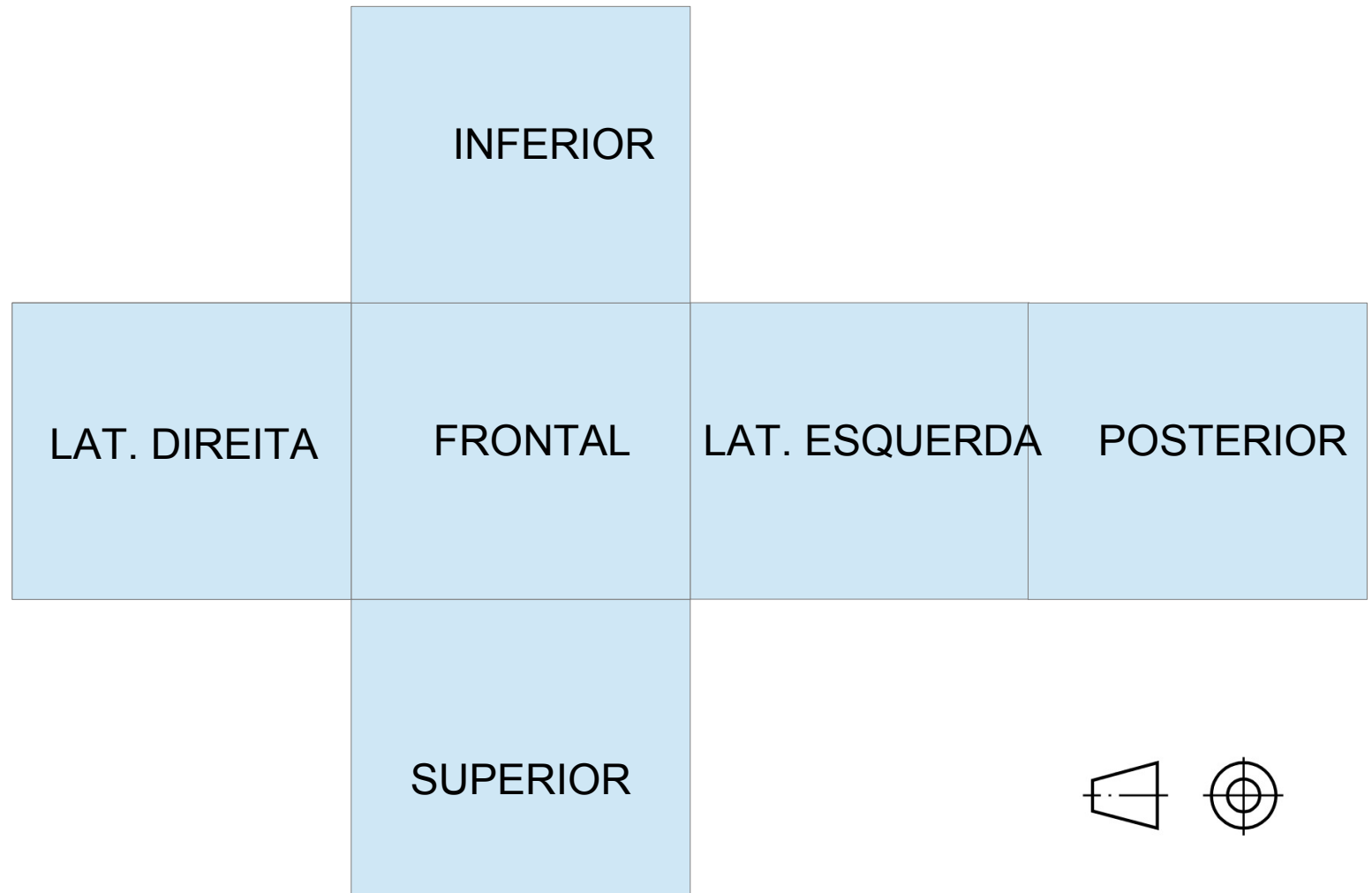

Posicionamento 1 diedro



Figura 4-(a)



Figura 4-(b)

Figura 4

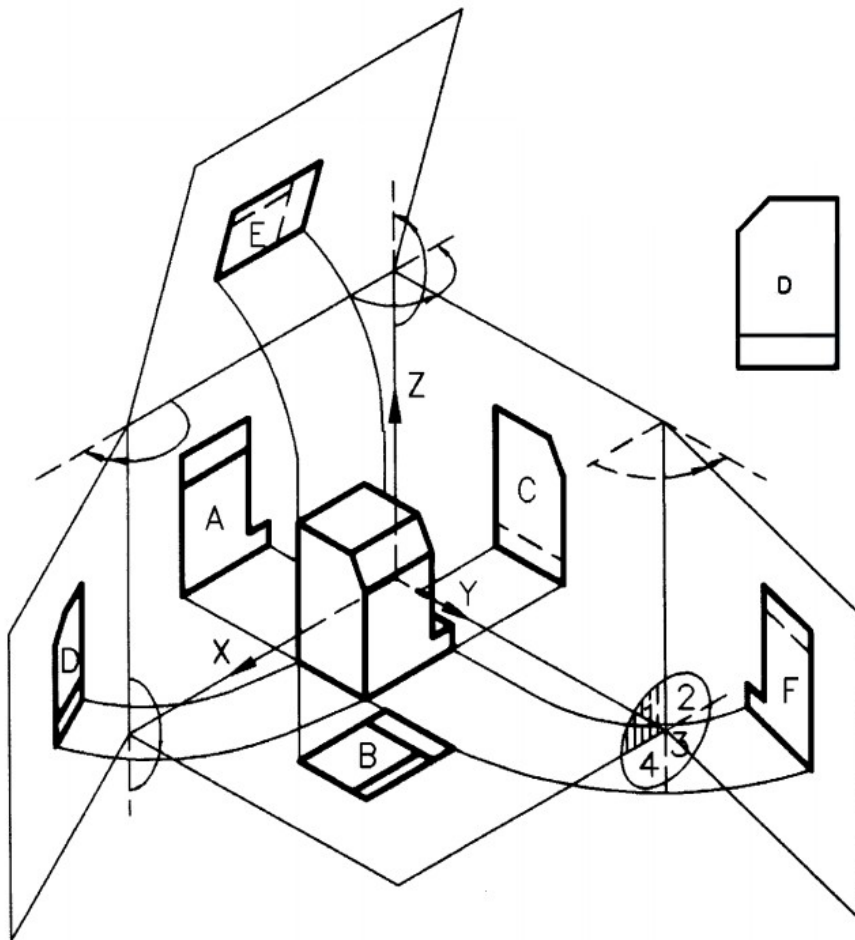
Posicionamento 3 diedro

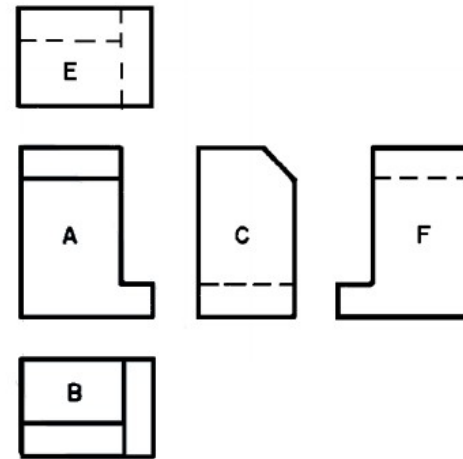
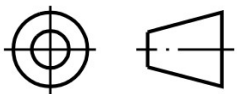
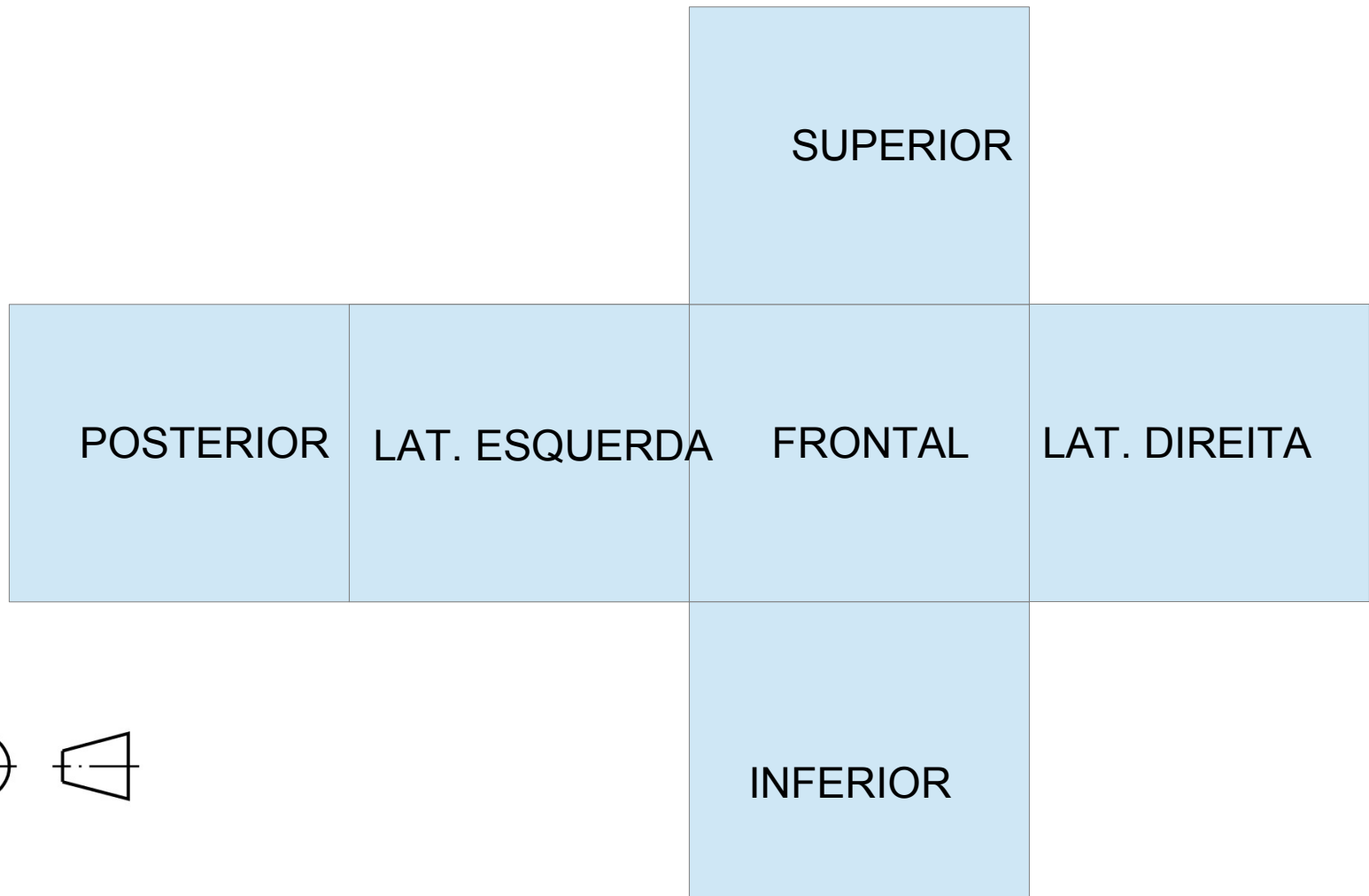

Posicionamiento 3 diedro



Figura 5-(a)

Figura 5-(b)

Figura 5

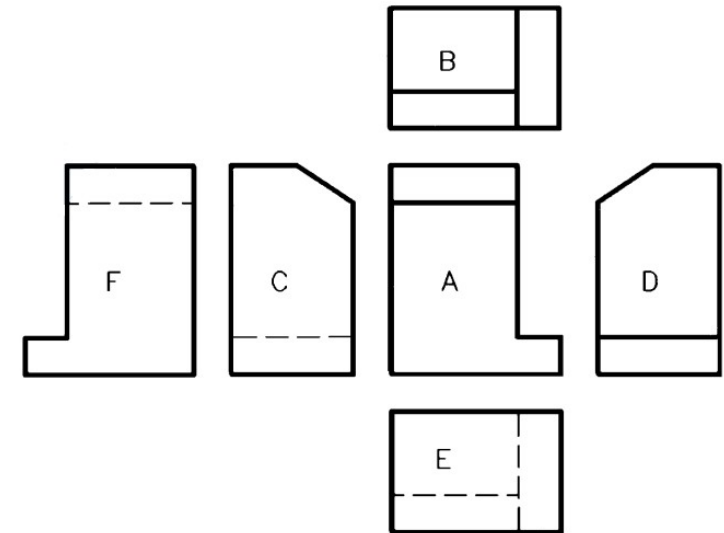
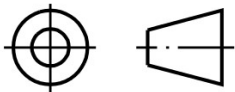
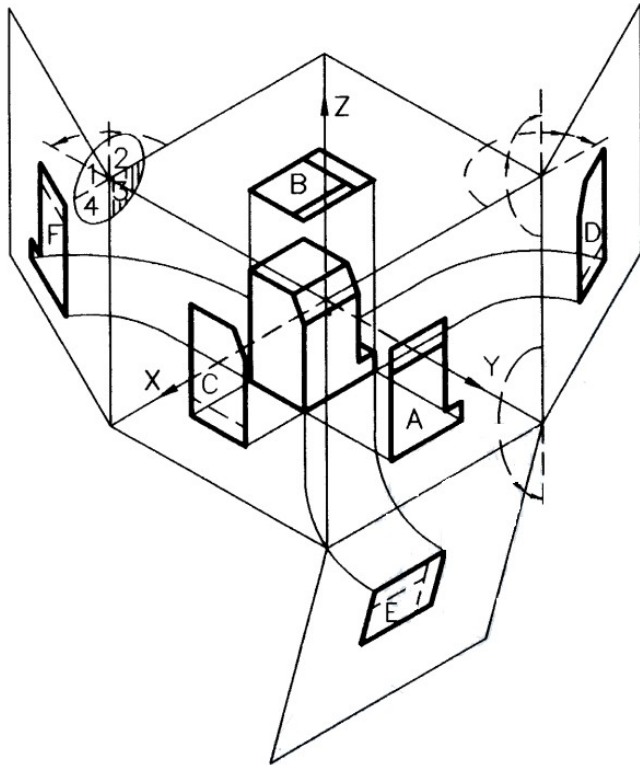

AutoCAD

Sistema de coordenadas cartesianas

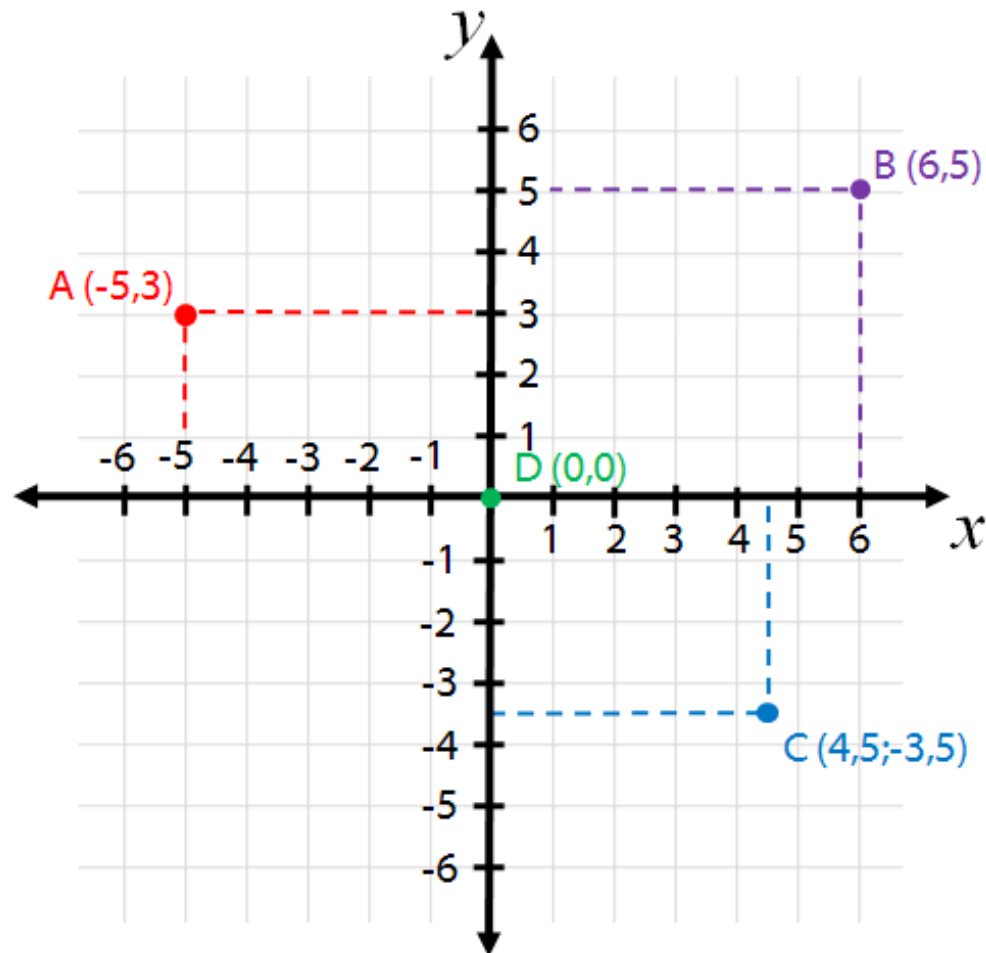

Sistema de coordenadas polares

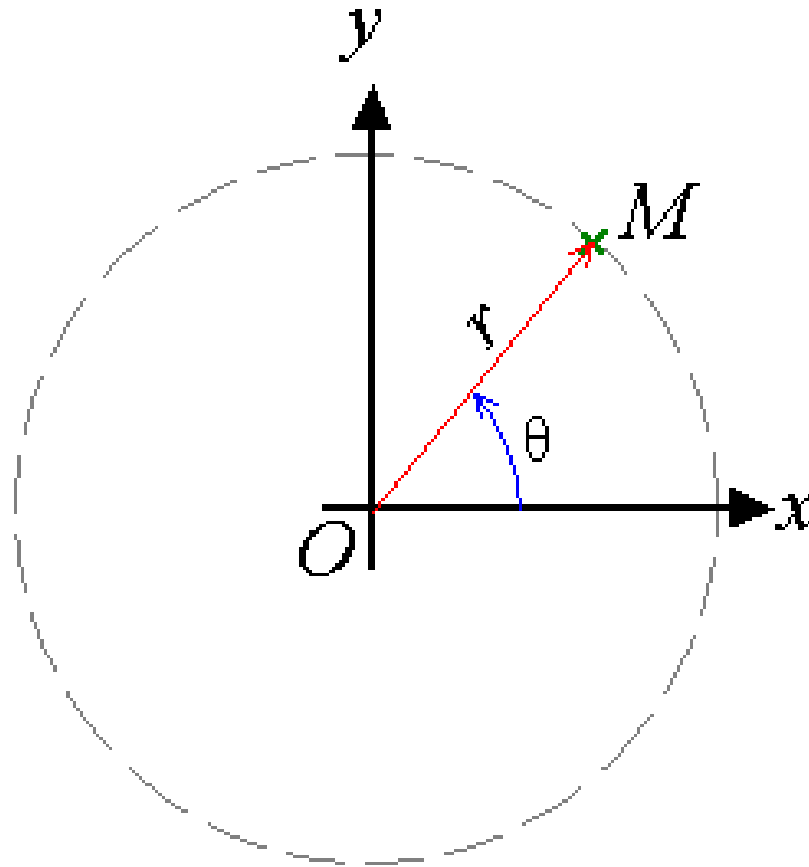



AutoCAD – Desenhando linhas

Desabilite os botoes SNAP, ORTHO, OTRACK, DYN

Crie uma linha utilizando os comandos:

line

0.0,0.0

9.5,9.5

Em seguida, use o comando:

* View -> Zoom -> Extents

para visualizar a linha



AutoCAD – Desenhando linhas

Desabilite os botoes SNAP, ORTHO, OTRACK, DYN

Crie uma linha utilizando os comandos:

line

0.0,0.0

9.5,9.5

Em seguida, use o comando:

* View -> Zoom -> Extents

para visualizar a linha

AutoCAD – Desenhando linhas

Desabilite o botão DYN

Desenhe o objeto ao lado
utilizando coordenadas
cartesianas **absolutas**:

line

0.0,0.0

10.0,0.0

20,10

...

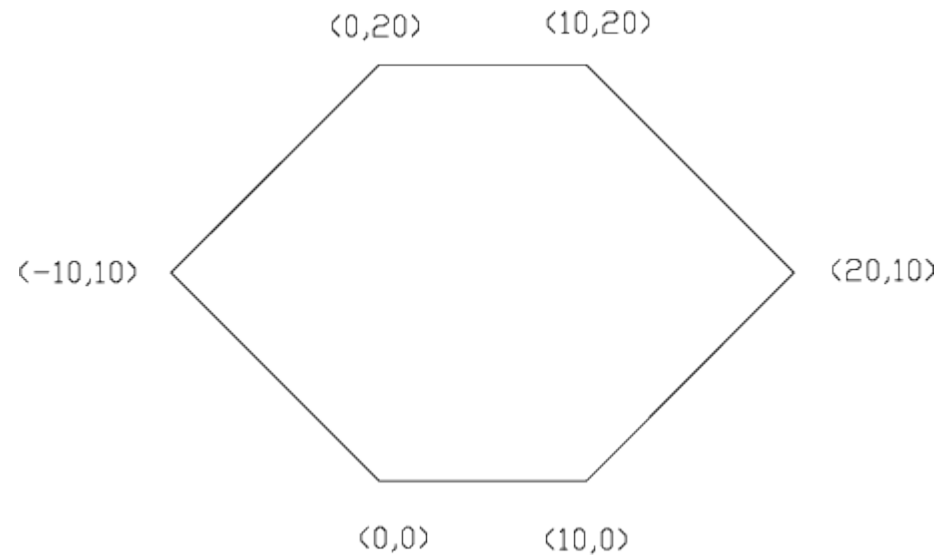

AutoCAD – Desenhando linhas

Desabilite o botao DYN

Desenhe o objeto ao lado
utilizando coordenadas
cartesianas **relativas**:

line

0.0,0.0

@10.0,0.0

@10,10

...

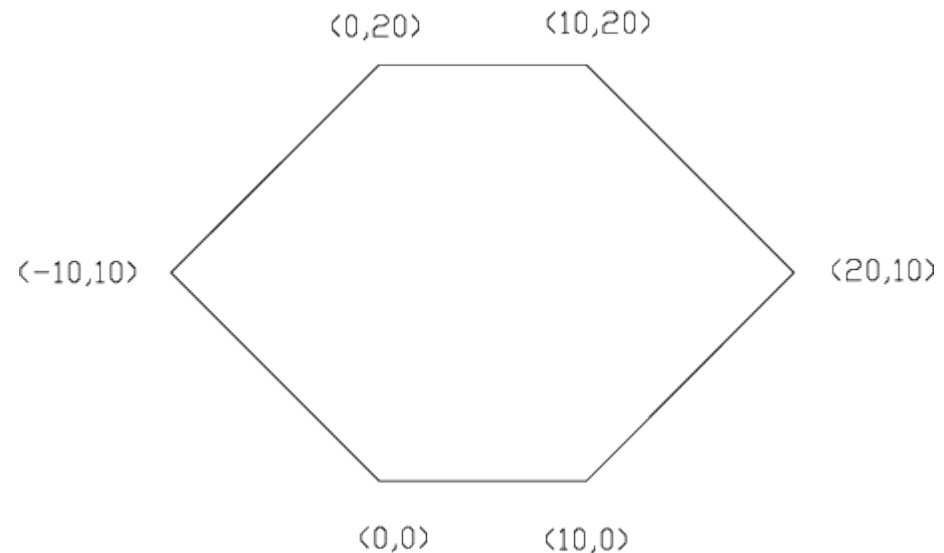

AutoCAD – Desenhando linhas

Desabilite o botão DYN

Desenhe o objeto ao lado
utilizando coordenadas
polares absolutas:

line

10<0

3<45

...

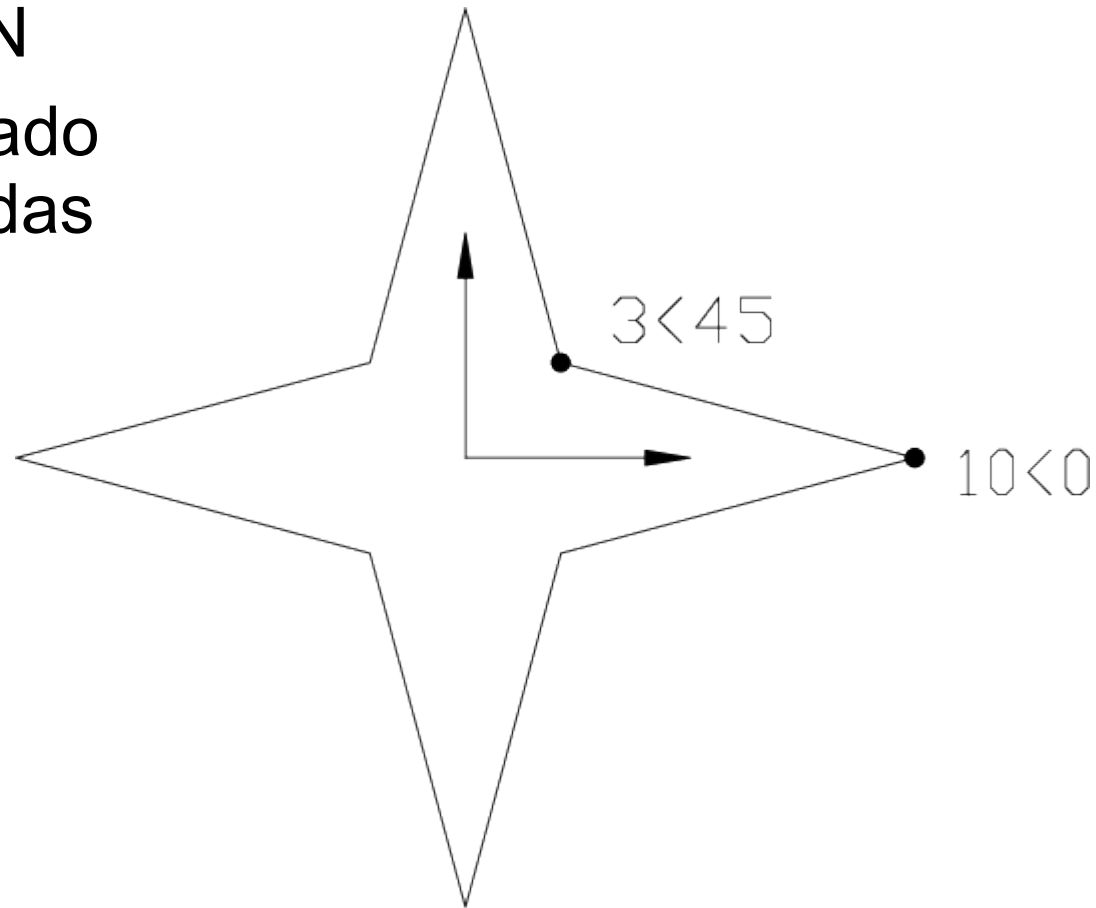

AutoCAD – Desenhando linhas

Desabilite o botao DYN

Desenhe o objeto ao lado
utilizando coordenadas
polares relativas:

```
line  
0,0  
@20<0  
@10<30  
...
```



AutoCAD - exercício

- Desenhe as vistas:
 - Frontal
 - Superior
 - Lateral esquerda
 - (Use o 1 diedro)
 - Habilite o botão OSNAP para voltar ao final de uma linha já desenhada
 - Cavalera com ângulo de 45 graus

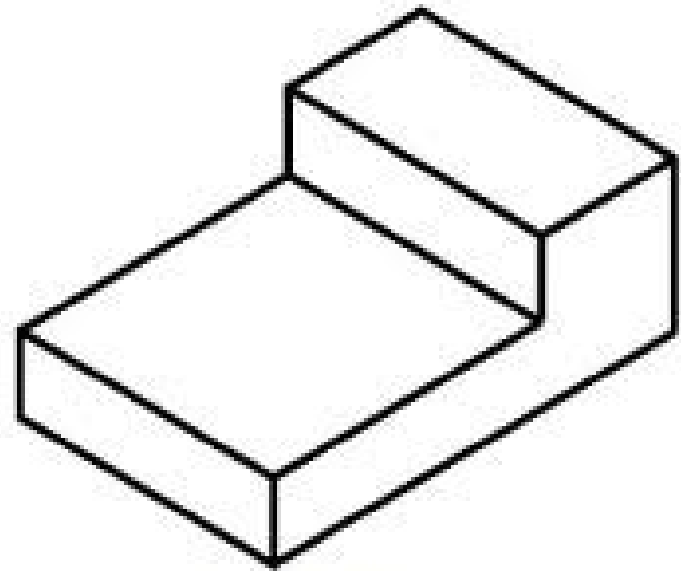

Modelo nº 1

Projeções - exercícios

